

2009 E-Van

Step: 1

Tilt steering wheel down.

Step: 2

Pull forward on dash bezel and disconnect all electrical connectors behind bezel. (See figure A)

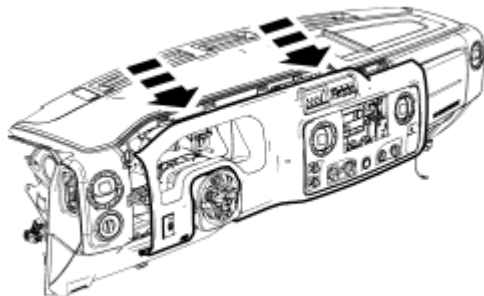

Figure A

Step: 3

Using a 7mm socket unscrew four screws holding radio and pull radio forward. (See figure B)

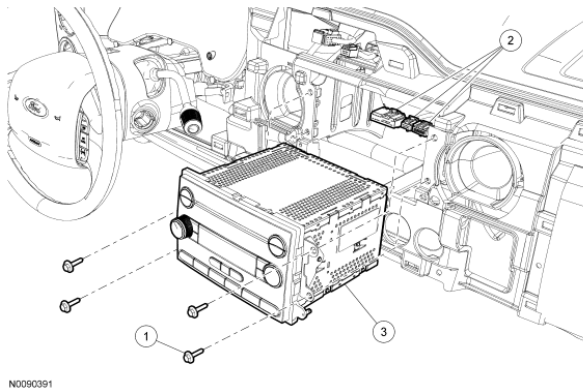

Figure B

Step: 4

Disconnect 24 Pin Main Radio Connector and connect supplied 24 pin T-harness.

Step: 5

Route the harness across dash through passenger side and up side A-pillar.

* note if installing behind sun visor route cable up driver side

Step: 6

Remove the A-pillar trim by first removing the assist handle covers and remove the two bolts holding the handle to the body, then release the upper retaining clip by pulling down at the top of the A-pillar trim and finally pull down to remove the remainder clips and remove A-pillar trim. (See figure C)

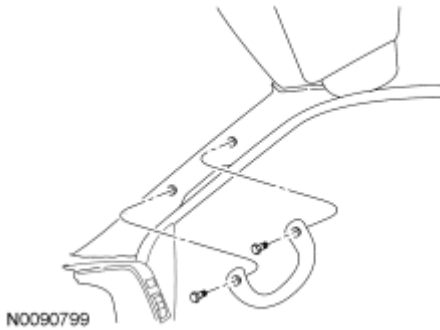

Figure C

Step: 7

Route Harness to opening cut in headliner and connect to Bluetooth unit.

Step: 8

Reassemble A-pillar/ Radio and Dash bezel (note Assist Handle requires torque of 106lb per inch)