

Q:Rear-view mirror is not powered.

A:Make sure that ACC, B+, GND are well connected, and that the filter box's fuse is not burnt out.

Q:The video displayed on the screen is overlapped by the rolling shadow of another video.

A:Make sure that the video extension interface is in good condition. If this still exists, it is recommended to use a video extension cable with a shielding layer, as shown in the following picture.



No entertainment video is permitted when driving except the demo for navigation and backup camera display!

*** This manual is only for your reference, please check the actual product as the standard!**

FLTW-7692V3 LCD Display Mirror

USER MANUAL



CONTENTS

The package contains the following:

- 01 Rearview mirror monitor
- 02 User manual
- 03 Wire cover
- 04 Wire control
- 05 Wire harness

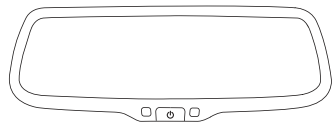

01

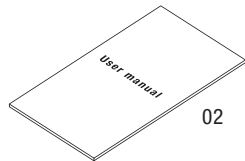

02

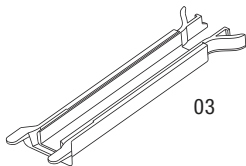

03

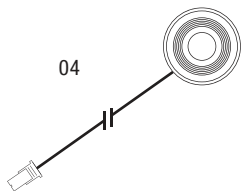

04

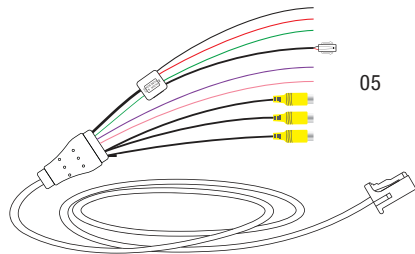

05

FEATURES

- 7.2 inch wide LCD display screen
- 3 analog video inputs
- Adjustable Back up guide lines
- Touch screen button
- Back-up camera display
- Automatic brightness adjustment
- Channel switch among RIGHT, LEFT, and CAMERA
- Trigger wires for reverse/ left/ right

SPECIFICATIONS

- Screen size: 7.2 inch
- Aspect resolution: 1280(H)*390(V)
- Working temperature: -20°C~+65°C
- Display screen: TFT-LCD
- Working voltage: DC 10V-DC 16V
- Signal system: PAL/Auto/NTSC

HOW TO INSTALL MIRROR MONITOR

Remove the original mirror

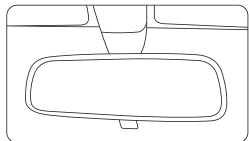

Car factory original mirror

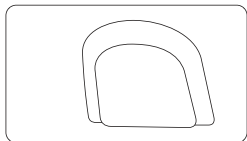

The plate on the windshield

Different cars have different brackets. It depends on your vehicle maker and manufacturer. There are many methods to remove the original rear view mirror, however, please don't force the mirror off the bracket.

The manufacturer will not be responsible for damage caused to your car by wrong installation of the mirror.

Install mirror monitor on the plate

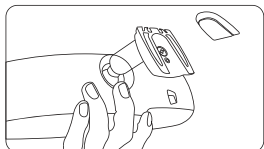

Take down your original mirror, and make the mirror monitor ready

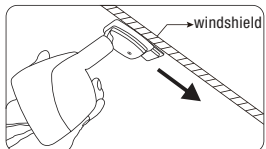

Install rear view mirror along this direction

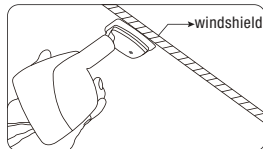

Please make sure to install the mirror to the end of the bottom without any loose

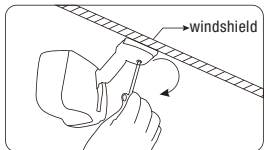

Contrarotate the fixed rear view mirror
Torque is about 0.8-1.3 N.m

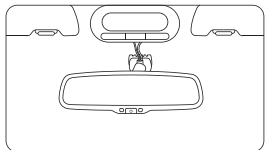

NOTE: Always use caution, DO NOT force the mount. We will not be responsible for broken windshields. If you are not sure how to remove or re-install the mirror seek trained, qualified help.

CAUTION!

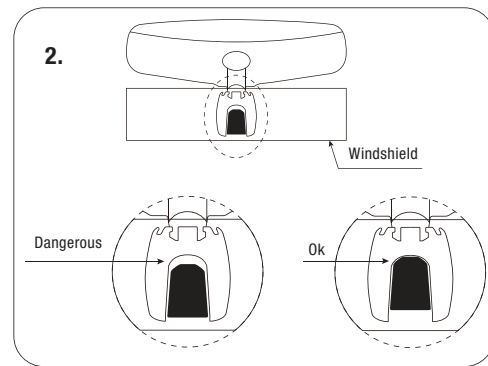
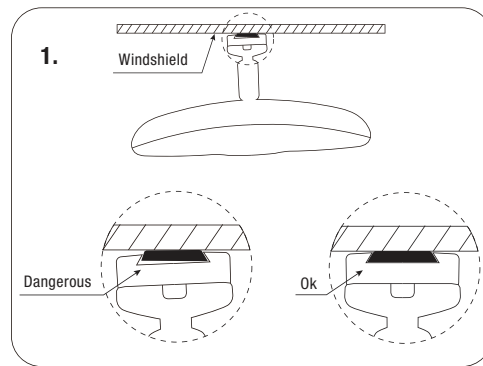

HOW TO WIRE

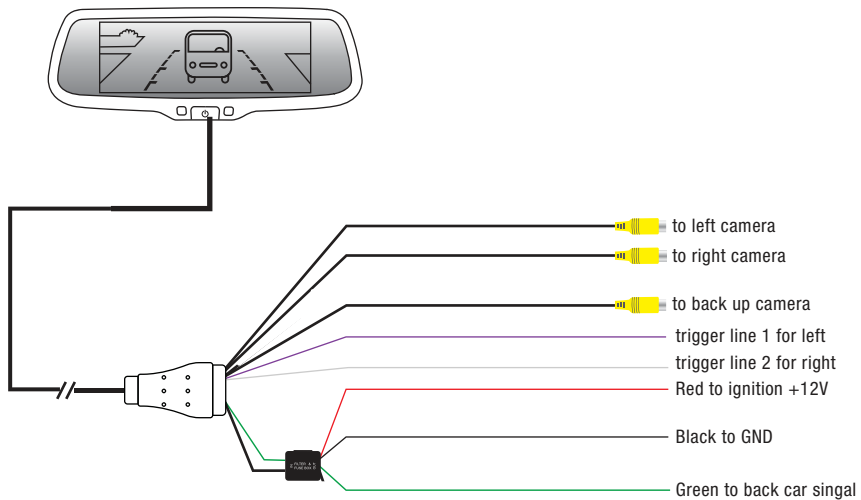

How to install wire harness, wire cover, cable cover and connector cable on the mirror?

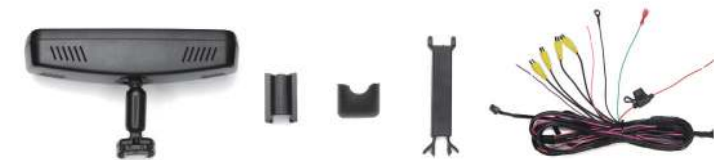

NOTE: The picture may not be in line with this type of mirror, just to demonstrate the installation method.

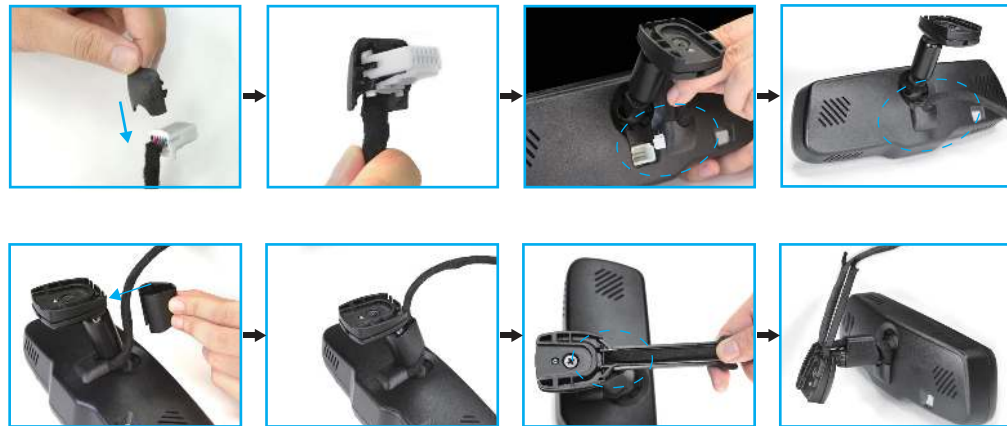

BUTTONS OPERATION

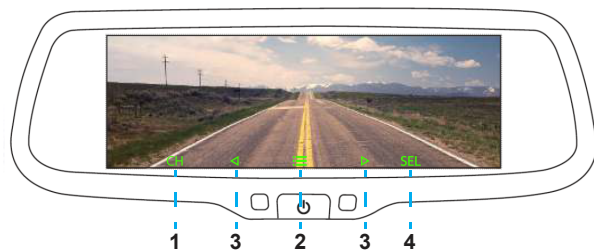

1	Switch among different video channels		
2	Menu setting		
3	Left/Right menu selection	4	Select button

BACK UP CAMERA DISPLAY

When the car is in reverse, the monitor will automatically display back up camera.

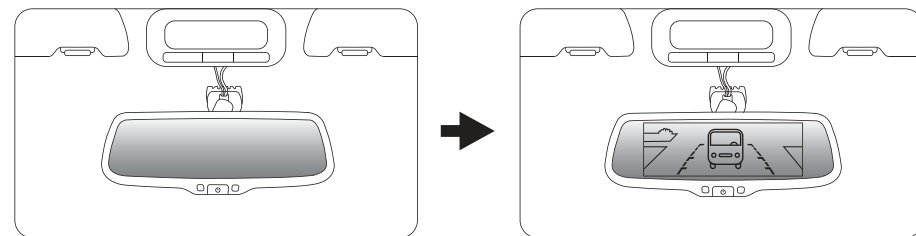

AUTOMATIC BRIGHTNESS ADJUSTMENT

The brightness of screen varies with ambient light, thereby, to make driver get a clear and comfortable image when reversing.

WEAK LIGHT When ambient light is weak, the screen will automatically reduce the brightness and get better vision.

STRONG LIGHT When ambient light is strong, the screen will automatically increase the brightness and get better vision.